

REVISIONS			
REV.	DESCRIPTION	DATE	APPROVED
A	PRODUCTION RELEASE	10/19/06	K.R.
B	REVISED PER ECO #8816	12/4/06	K.R.
C	REVISED PER ECO #8899	2/12/07	K.R.

Nominal Coil Voltage	Part Number
12 Vdc	5A1-520802N

REVISIONS	C	C	C	C		
SHEET NO.	1	2	3	4		
APPROVALS			DATE			
DRAWN	S. LEE		10/18/06			
ENG	G. NICKLAUS		10/18/06			
ENG. MGR.	R. SZNUK		10/18/06			
SALES MGR.	V. HARTER		10/19/06			
Q.A. MGR.	N. SANDERS		10/19/06			
MFG. MGR.	R. GONZALEZ		10/19/06			



DowKey®
Microwave
CORPORATION

4822 McGrath Street
Ventura, CA. 93003-5641
PH: (805) 650-0260
FAX: (805) 650-1734

A **DOVER** TECHNOLOGIES COMPANY

SWITCH, 10 POSITION, NORMALLY OPEN
SMA-FEMALE CONNECTORS
CAN INTERFACE

CODE IDENT. NO.

00471

DWG. NO.

5A1-520802N

SCALE NONE

FINAL ASSY:

SHEET 1 OF 4

OUTLINE DRAWING:

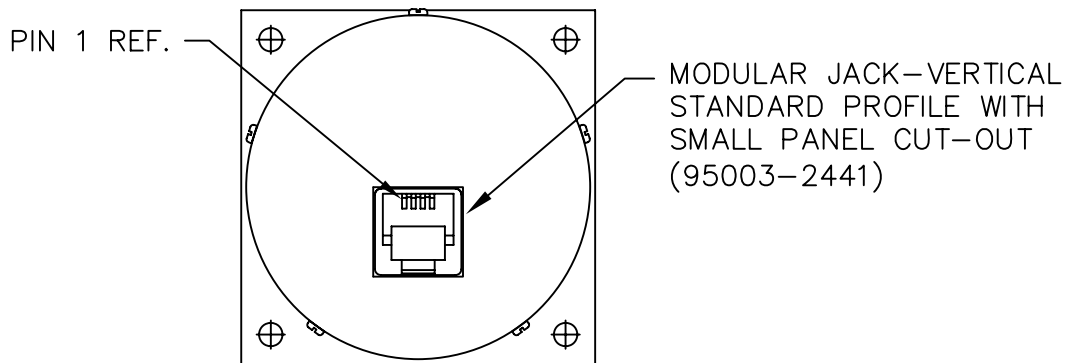

CAN INTERFACE CONTROL CONNECTOR

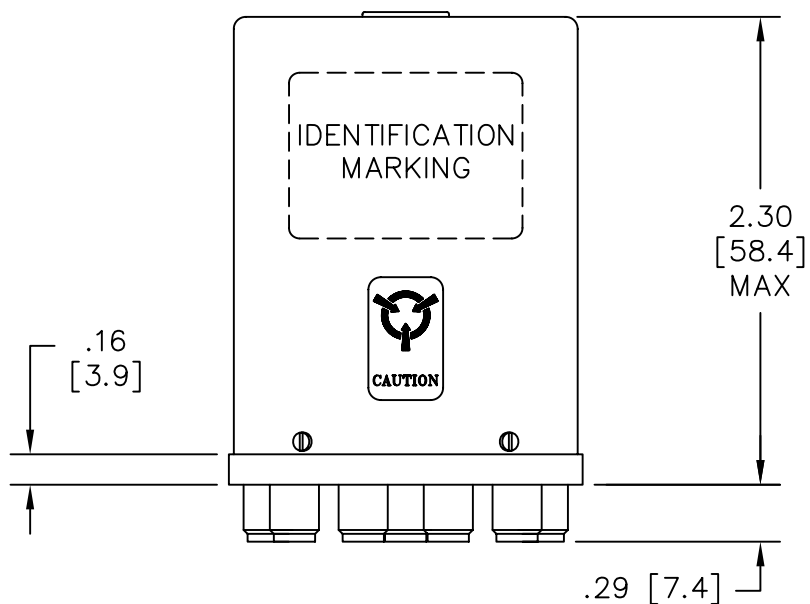
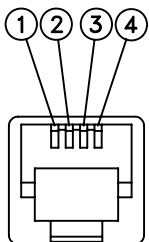

11X SMA-FEMALE CONNECTORS
10X EQ. SPACED ON $\phi 1.400$ B.C.

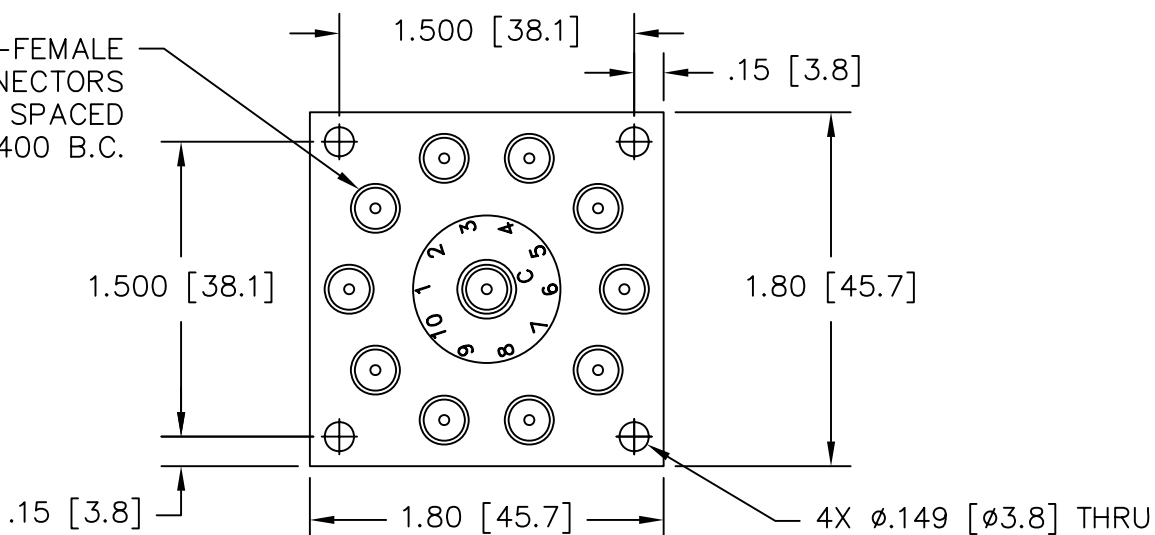

[] MILLIMETERS

UNLESS OTHERWISE SPECIFIED TOLERANCES ARE:
.XXX ±.010 ANGLES: ±3°
.XX ±.030

CODE IDENT. NO.
00471

DWG. NO.
5A1-520802N

REV.
C

SCALE NONE

SHEET 2 OF 4

SPECIFICATIONS:

1. RF CHARACTERISTICS:

1.1 FREQUENCY (GHz):	DC-4	4-8	8-12.4	12.4-18
1.2 VSWR (RATIO MAX.):	1.20:1	1.30:1	1.40:1	1.60:1
1.3 INSERTION LOSS (dB MAX.):	.20	.30	.40	.60
1.4 ISOLATION (dB MIN.):	70	65	60	55
1.5 RF POWER (WATTS CW MAX):	100	70	60	50
1.6 IMPEDANCE (NOMINAL):	50 OHMS			

2. ACTUATION DATA:

2.1 OPERATING VOLTAGE:	11-14Vdc (12Vdc NOMINAL)
2.2 OPERATING CURRENT:	340 TYP @ 12Vdc & 20°C
2.3 SWITCHING TIME:	15mS MAX
2.4 OPERATING MODE:	NORMALLY OPEN, CAN INTERFACE

3. MECHANICAL:

3.1 CONTACT ARRANGEMENT:	SP10T
3.2 RF CONTACTS:	BREAK BEFORE MAKE
3.3 WEIGHT:	9oz. (260g.) MAX
3.4 DESIGN LIFE:	1,000,000 CYCLES MIN

4. ENVIRONMENTAL:

4.1 OPERATING TEMPERATURE:	-25°C TO +65°C
4.2 STORAGE TEMPERATURE:	-55°C TO +85°C
4.3 SEAL:	SAND AND DUST

5. FINISH:

5.1 RF CAVITY:	ALUMINUM, ELECTROLESS NICKEL
5.2 ENCLOSURE:	ALUMINUM, ELECTROLESS NICKEL
5.3 RF CONNECTOR SHELLS:	CRES, PASSIVATE

CODE IDENT. NO.	DWG. NO.	REV.
00471	5A1-520802N	C
SCALE NONE		SHEET 3 OF 4

SCHEMATIC:

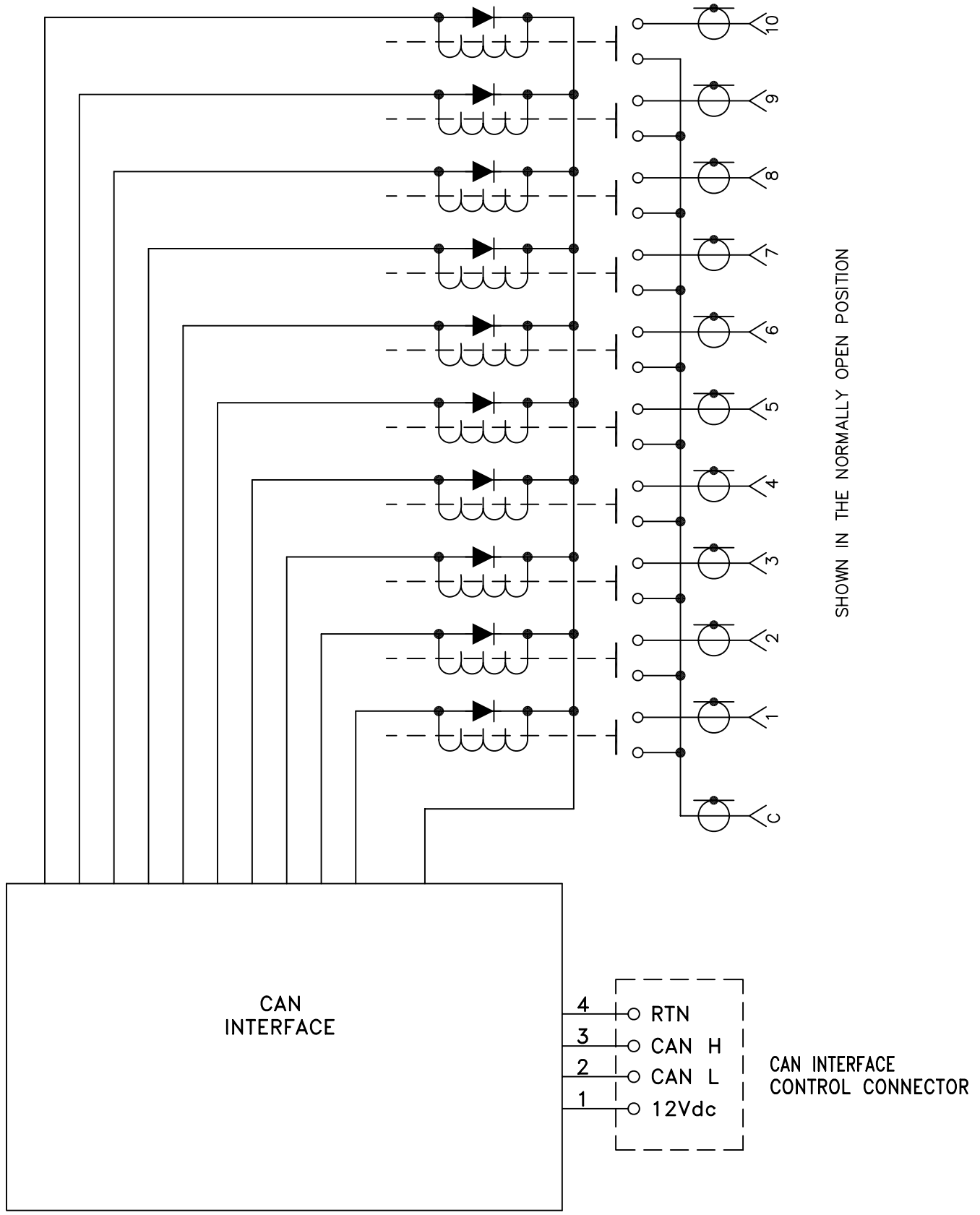

SHOWN IN THE NORMALLY OPEN POSITION

CODE IDENT. NO. 00471	DWG. NO. 5A1-520802N	REV. C
SCALE NONE	SHEET 4 OF 4	